

Description :

Thermocouples according DIN 43733* for industrial applications. Connection heads type A according DIN 43729. *Other connection heads upon request*

Installation :

Direct installation into the process with support tube from metal and compression fitting or limiting flange.

Thermocouples :

Type K (NiCr-Ni) according to DIN EN 60584 / IEC 584

Type S (Pt10Rh-Pt) according to DIN EN 60584 / IEC 584

The DIN-Types R and B available upon request.

Temperature Limits :

FeCu-Ni Type S : max. 1200 °C

NiCr-Ni Type K : max. 1600 °C

Accuracy :

Class 1 according to DIN IEC 60584 / IEC 584

The tolerances for Pt 100 RTD's you can see in the chart "Values and Tolerances for thermocouples" in the appendix.

Electrical connection:

Ceramic connection terminal for 2-, 3- or 4- wire connection. Also available with mounted head transmitter 4...20 mA (Only in connection heads type BUZ-H)

**Variant from the DIN standard are also other executions available (Connection, Length or diameter).*



Picture shows execution with connection head type B

Suggestions for installation of straight thermocouples

Limiting flange

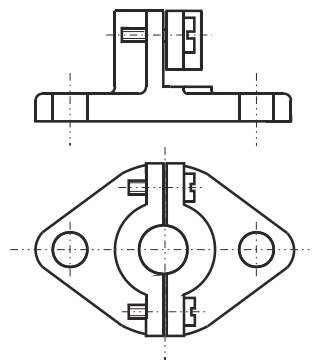

Compression fitting

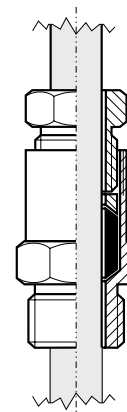

Thermocouples

With ceramic protection tube

Datasheet 822.1

Straight Thermocouples

Protection tube	
Bestellcode	F G
Ø 15 x 2mm Mat. C610 suitable up to 1500°C support tube 200mm 22 x 2	7 8
Ø 15 x 2mm Mat. C799 suitable up to 1600°C support tube 200mm 22 x 2	7 9
Ø 24 x 2,5mm suitable up to 1500°C support tube 200mm 32 x 2	9 8
Ø 24 x 2,5mm suitable up to 1600°C support tube 200mm 32 x 2	8 6

Wire Ø (Type S only)	
Bestellcode	H I
Typ K or special type	X X
Typ S 0,35mm	0 1
Typ S 0,5mm	0 2

Number of thermocouples	
Ordering code	J K
Single TC	1
Double TC	2

Thermocouples	
Bestellcode	LM
Type K (Ni - CrNi)	1 2
Type S (Pt10Rh - Pt)	1 3
Special type	9 9

Additional equipment	
Ordering code	O
Without	0
Limiting flange	1
Compression fitting	2

For compensation see datasheet 10.30

Ordering-code :

for ordering please fill out all empty digits in the order code on the right.

The code numbers for all free digits you find in the charts above.

For ordering please declare in plain text :

Insertion length (L_i): With transmitter / measuring range:
 mm °C to°C

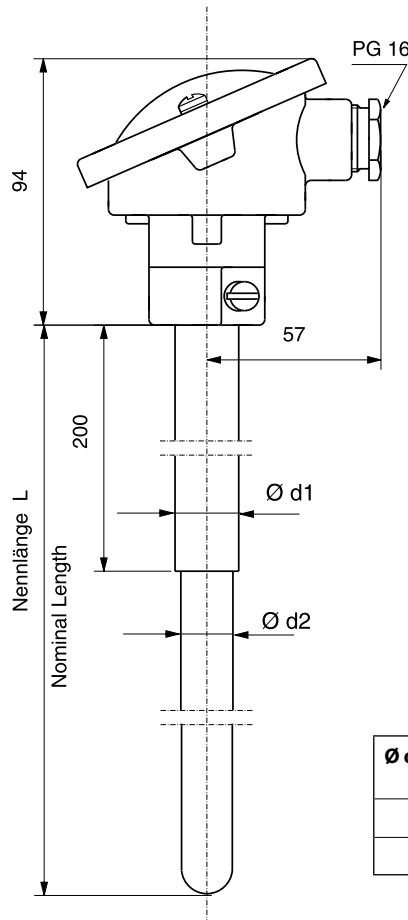

Picture shows execution with connection head type A

Ø d2 / Ceramic tube	Ø d1 / Support tube	Ø Compression fitting
15mm	22mm	G 1"
24mm	32mm	G ¼"

Transmitter *2	
Ordering code	N
Without	0
According datasheet 844.00 *3	1
According datasheet 846.00 *4	3
According datasheet 847.00 *5	5
According datasheet 848.00 *6	6
Special type	9

- *1 Terminal heads see Infosheet 81.02
- *2 Declare measurement range in plain text
- *3 Analog, Low- Cost
- *4 Digital, Low- Cost, without seperation
- *5 Digital, with seperation
- *6 Digital, with seperation, HART® compatible
- *7 Wiring schemes see datasheet 802.0

If you use a transmitter you also have to use a connection head type BUZ - H

