

## Description :

Weld - in protection tubes type KE-SS

- with integrated clamp connection for thermometers with plain stem (our type 10)

Customized executions are available upon request

- Different materials available



## Dimension drawing

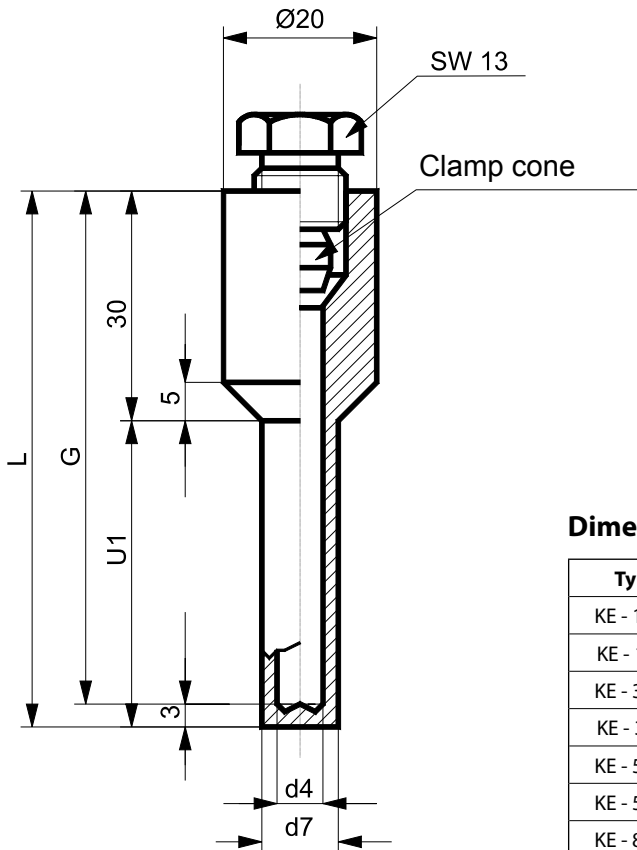

## Dimension table:

Type	DN	d4	d7	L	U1	G	usable for
KE - 15 - 6	6	7	10	45	15	42	dial thermometer Sensors
KE - 15 - 8	8	9	12	45	15	42	
KE - 30 - 6	6	7	10	60	30	57	
KE - 30 - 8	8	9	12	60	30	57	
KE - 50 - 6	6	7	10	80	50	77	
KE - 50 - 8	8	9	12	80	50	77	
KE - 80 - 6	6	7	10	110	80	107	
KE - 80 - 8	8	9	12	110	80	107	
KE - 100 - 6	6	7	10	130	100	127	
KE - 100 - 8	8	9	12	130	100	127	
KE - 99	special design according customers request						

The insertion length should be  $L1 = L + 15\text{mm}$

# Protection tube / weld-in type

solid drilled, with integrated clamp connection

# Datasheet 14.10

Protection tubes

Type KE -	
Ordering code	FG
15 - 6	01
15 - 8	02
30 - 6	03
30 - 8	04
50 - 6	05
50 - 8	06
80 - 6	07
80 - 8	08
100 - 6	09
100 - 8	10
Special design	9

Material		
Ordering code		H
Steel C 22.8	(1.0460)	1
Stainless steel	(1.4571)	2
13CrMo4-4	(1.7335)	4
16Mo3	(1.5415)	5
Special material		9

Certificate acc. DIN EN 10204	
Ordering code	M
Without	0
Certificate 2.2	1
Certificate 3.1	3
Certificate 3.2	4

*The certificates 2.2 and 3.1 are also available with a pressure inspection*

### Ordering-code :

for ordering please fill out all empty digits in the order code on the right.

*The code numbers for all free digits you find in the charts above.*

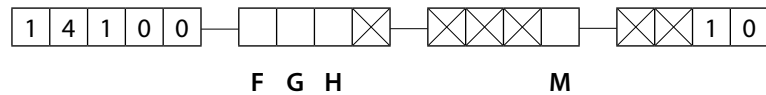

### For ordering please declare in plain text :

Special material :

Special length:

Special bore:

.....

..... mm

..... mm