

Description :

Compression fittings for gas tight mounting
Stainless steel 1.4571

- weld - in ball type (thermometer can stay in different angels)

screw - in type with different threads available.

- variable insertion length (thermometer with plain stem can be fixed in all positions)



weld-in compression fitting

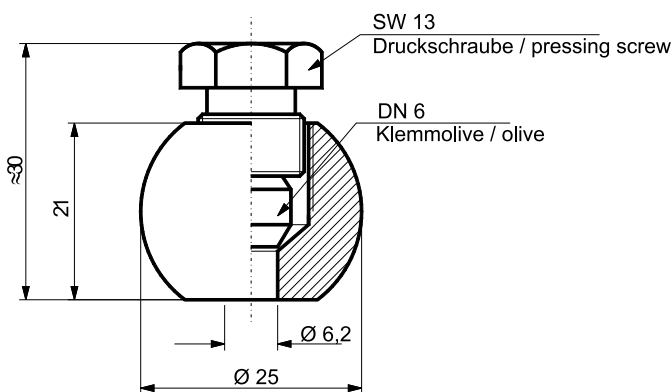

screw-in compression fitting

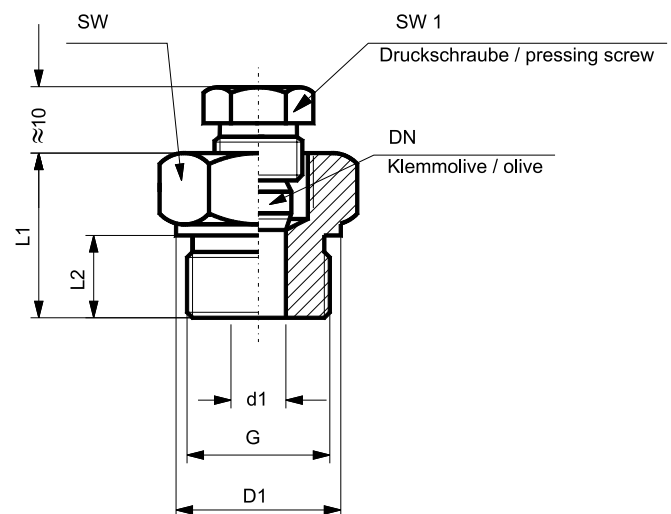

Diameters and connections for screw-in type

Process connection G	D1	SW	L1	L2	DN	d1	SW1	N	suitable for	
G 1/2"	26	27	30	15	3*	4	13	G 1/4"	dial thermometer	
M 20 x 1,5					6	7				
G 3/4"	8	8,5								
M 27 x 2	10	10,5								
G 1"	40	41	34	17	12	12,5	17	G 3/8"		Sensors

* olive made of teflon

Connection type	
Ordering code	F
weld-in ball	1
screw-in connector	2

The following choices are only for the screw-in connector:

Process connection	
Ordering code	J
G 1/2"	1
G 3/4"	2
G 1"	3
M 20 x 1,5	7
Special thread	9

Diameter d1	
Ordering code	K
for Sensor 3mm	1
for Sensor 6mm	2
for Sensor 8mm	3
for Sensor 10mm	4
for Sensor 12mm	5
Special diameter	9

Ordering-code :

for ordering please fill out all empty digits in the order code on the right.

The code numbers for all free digits you find in the charts above.

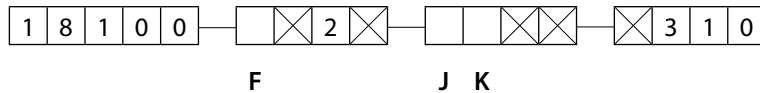

For ordering please declare in plain text :

Special material :

.....

Special length:

..... mm

Special bore:

..... mm